

82-1500
80-1300

-53-

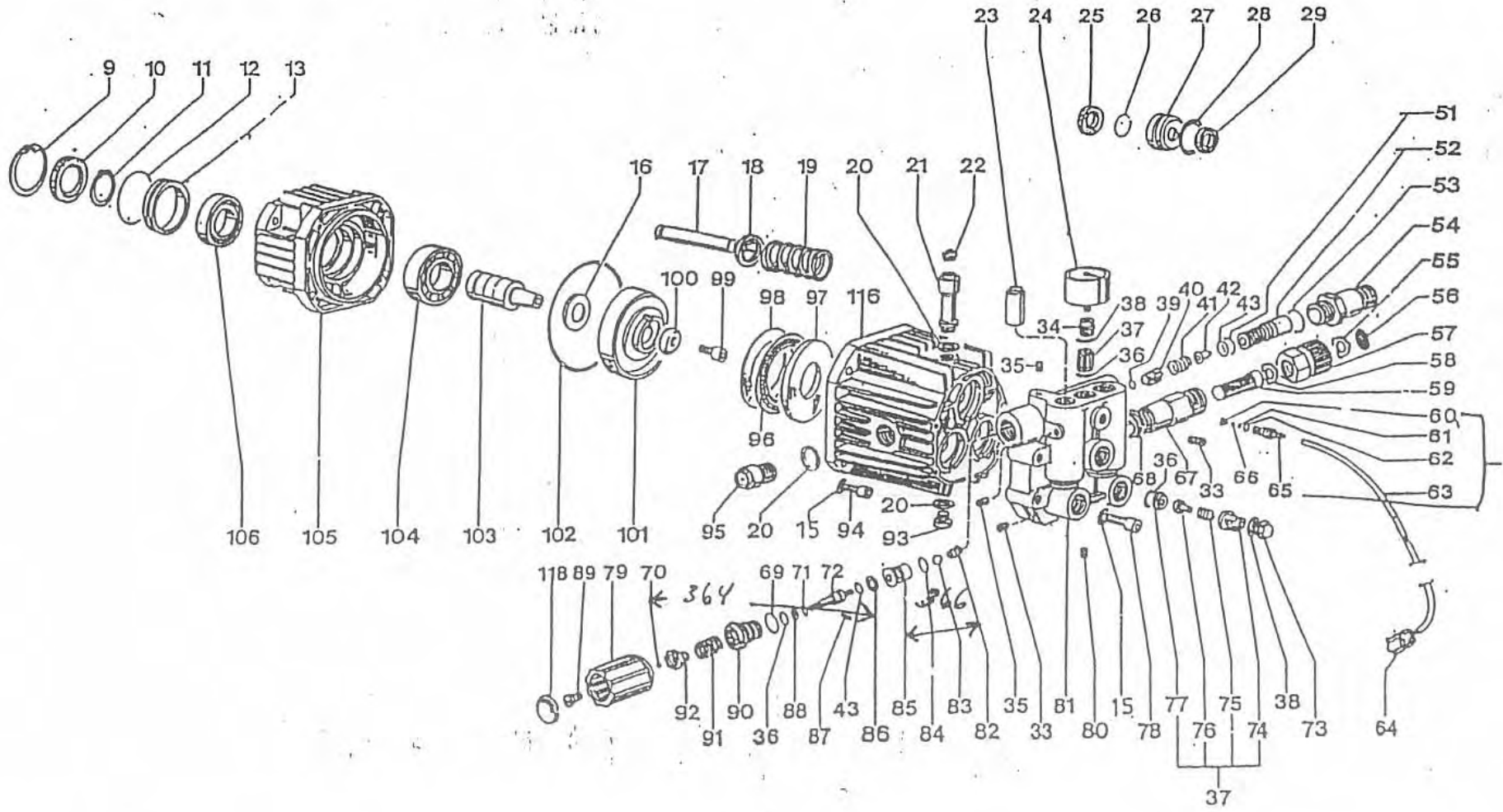

COLEMAN GAS DRIVEN UNIT

<u>POSITION</u>	<u>CLPM #</u>	<u>DESCRIPTION</u>
9	0000207	CIRCLIP 156
10	0000209	OIL SEAL
11	0000210	CIRCLIP D. 30
12	0000226	O-RING 2200
13	0000227	SPACER
15	0000362	WASHER
16	0000228	WASHER
17	0000229	PISTON D. 15 MM
18	0000230	PISTON RING
19	0000231	PISTON SPRING
20	0000069	ASBESTOS GASKET
21	0000067	OIL FILL TUBE
22	0000068	OIL PLUG
23	0000098	VALVE, CYLINDER SPACER
24	0000080	POWERMATE PRESSURE GAUGE
25	0000288	OIL SEAL
26	0000236	O-RING 119
27	0000237	BOUCHING
28	0000238	O-RING 2106D.
29	KIT 3-0286	WATER SEAL
33	0000363	SCREW STCI G 1/8
34	0000239	VALVE PLUG GAUGE
35	0000240	SCREW M 8X8
36	0000093	O-RING 2050 D.
37	KIT 2-0297	COMPLETE VALVE
38	0000241	O-RING 2061 D.
39	0000094	O-RING 4X2
40	0000096	NO RETURN VALVE
41	0000127	SPRING FOR NO RETURN VALVE
42	0000098-1300 PSI	NOZZLE D. 1.8 (3HP) VENTURA
42A	0000355-1500 PSI	NOZZLE D. 2.0
43	0000099	O-RING 108
51	0000350	O-RING 2043
52	0000101	INJECTOR NIPPLE
53	0000351	O-RING 2075
54	0000352	HIGH PRESSURE OUTLET
55	0000187	GASKET
56	0000015	FILTER WATER INLET
57	0000021	GARDEN HOSE CONNECTOR
58	0000187	GASKET
59	0000016	SUCTION FILTER
60	0000091	CHEMICAL SPRING
61	0000089	O-RING 2018
62	0000088	O-RING 2031
63	0000256	CHEMICAL TUBE
64	0000087	CHEMICAL FILTER
65	0000353	CONNECTOR CHEMICAL SUCTION
66	0000090	STAINLESS STEEL BALL 3/16
67	0000252	INLET CONNECTOR G 3/4
68	0000232	ASBESTOS GASKET

<u>POSITION</u>	<u>CLPM #</u>	<u>DESCRIPTION</u>
69	0000111	O-RING 15X2
70	0000135	FLEXIBLE TUBE
71	0000109	O-RING 2025
72	0000108	BY-PASS PISTON
73	0000257	VALVE PLUG
74	0000126	VALVE CAGE
75	0000127	VALVE SPRING
76	0000128	VALVE PLATE
77	0000129	VALVE SEAT
78	0000258	SCREW M 8X45
79	0000356	PRESSURE REGULATION KNOB
80	0000260	SCREW G 1/4
81	0000357	PUMP HEAD
82	0000103	SPRING BY-PASS VALVE
83	0000104	STAINLESS STEEL BALL 5/16
84	0000100	O-RING 2037
85	0000358	BRASS VALVE SEAT
86	0000106	BACK RING FOR O-RING 108
87	0000107	PIN
88	0000110	BACK RING FOR O-RING 2025
89	0000150	MOUNTING SCREW KNOB
90	0000112	VALVE BODY BY-PASS
91	0000113-1300 PSI	PRESSURE REGULATION SCREW
91A	0000361-1500 PSI	PRESSURE REGULATION SCREW
92	0000114	PRESSURE REGULATION SCREW
93	0000272	BRASS OIL PLUG G 3/8
94	0000273	SCREW M 8X25
95	0000274	OIL SIGHT GLASS
96	KIT 8-0295	NEEDLE BEARING
97	KIT 8-0295	BEARING DISC
98	KIT 8-0295	BEARING DISC
99	0000275	SCREW M 8X20
100	0000276	WASHER
101	0000277-1300 PSI & PW0821500	CAM DISC 7 DEGREES 30"
101A	0000278-1500 PSI	CAM DISC 10 DEGREES
102	0000279	O-RING 3375
103	0000284	SHAFT
104	0000280	BEARING FRONT
105	0000281	ENGINE FLANGE
106	0000282	BEARING REAR
116	0000283	PUMP CARTER (PISTON HOUSING)
118	0000360	YELLOW BADGE ON PRESSURE REG. KNOB
*	0050913	COMPLETE PUMP PW0821500
*	0000045	COMPLETE PUMP PW0801300, CW0801300
*	0000046	COMPLETE PUMP PW0801500, PW0851500, CW0851500, & PW0861500

<u>KIT NO.</u>	<u>CLPM #</u>	<u>POSITIONS INCLUDED</u>
1	0000285	PISTON 17, 18, 19
2	0000297	VALVE 36, 37, 74, 75, 76, 77
3	0000286	WATER SEAL 29
4	0000287	BOUCHING 26, 27, 28, 25, 29
5	0000288	OIL SEAL 25
6	0000298	VALVE 34X1, 38X6, 73X5
7	0000348	CHEMICAL INJECTOR 60, 61, 62, 65, 66
8	0000295	NEEDLE BEARING 96, 97, 98
10	0000366	UNLOADER SEAT 82, 83, 84, 85
11	0000367	FLANGE ADAPTER BEARING 16, 99, 100, 101, 102, 104, 106
12	0000368	OIL SEAL 9, 10, 11, 12, 13
13	0000369-SPECIFY MODEL	ENGINE FLANGE ASSY. 9, 10, 11, 12, 13, 16, 99, 100, 101, 102, 104, 105, 106
14	0000364-1300 PSI	UNLOADER ASSY. 36, 43, 69, 70, 71, 72, 86, 87, 88, 90, 91, 92, 46
14	0000365-1500 PSI	UNLOADER ASSY. 36, 43, 69, 70, 71, 72, 86, 87, 88, 90, 91, 92, 46